

Copyright Reserved

The Contractor shall verify and be responsible for all dimensions. DO NOT scale the drawing - any errors or omissions shall be reported to Stantec without delay. The Copyrights to all designs and drawings are the property of Stantec. Reproduction or use for any purpose other than that authorized by Stantec is forbidden.

Notes

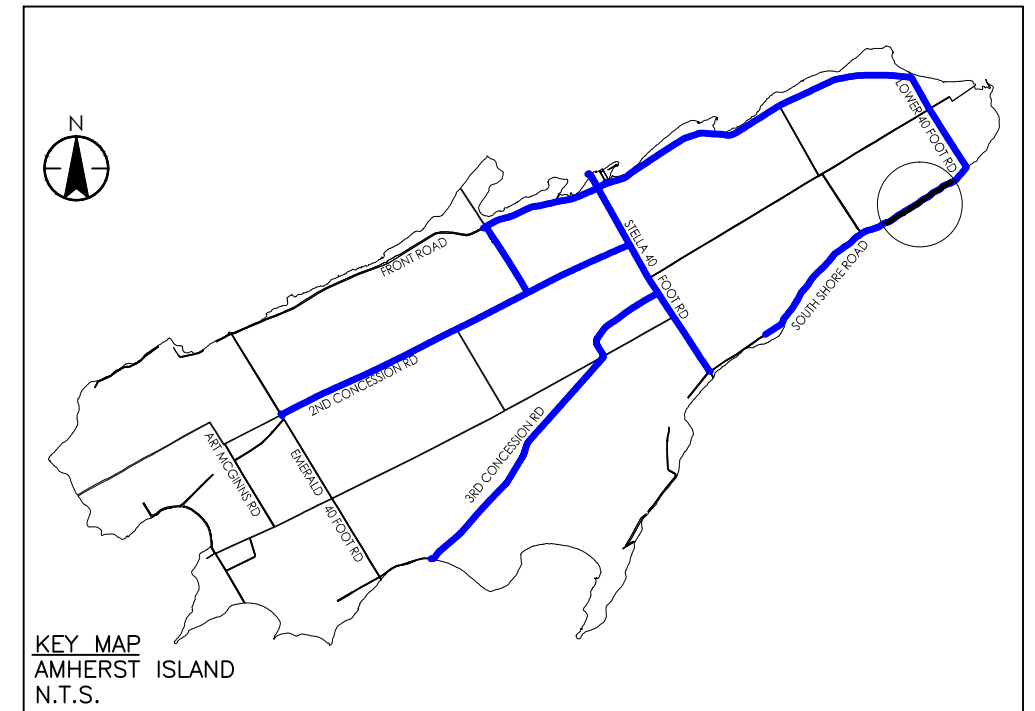

Legend

- EDGE OF PAVEMENT
- EXISTING PROPERTY LINE
- EXISTING FENCE
- DIRECTION OF DELIVERY
- ALIGNMENT OF PROP. ACCESS ROAD
- EXISTING HYDRO POLE
- EXISTING TREE
- EXISTING DRIVEWAY
- EXISTING SIGN
- LIMIT OF TEMPORARY GRADING AREA
- OBSTACLE FREE ZONE
(NOTE: THIS IS THE LIMIT OF SWEEP PATH OF THE BLADE OVERHANG FROM THE DELIVERY VEHICLE MOVEMENTS.)

Revision

Issued

File Name:

Permit-Seal

DESIGN WORK IN PROGRESS
INCOMPLETE
NOT FOR USE OR CONSTRUCTION

Client/Project

Windetric Inc.
AMHERST ISLAND WIND PROJECT
75MW WIND FARM
Amherst Island, Loyalist Township, Ontario

Title
**OVERALL SITE LAYOUT
MUNICIPAL ROAD USE**

Project No. 133560078
Drawing No. C020
Scale 1:500
Horizontal 10
Sheet 20 of 31
Revision A

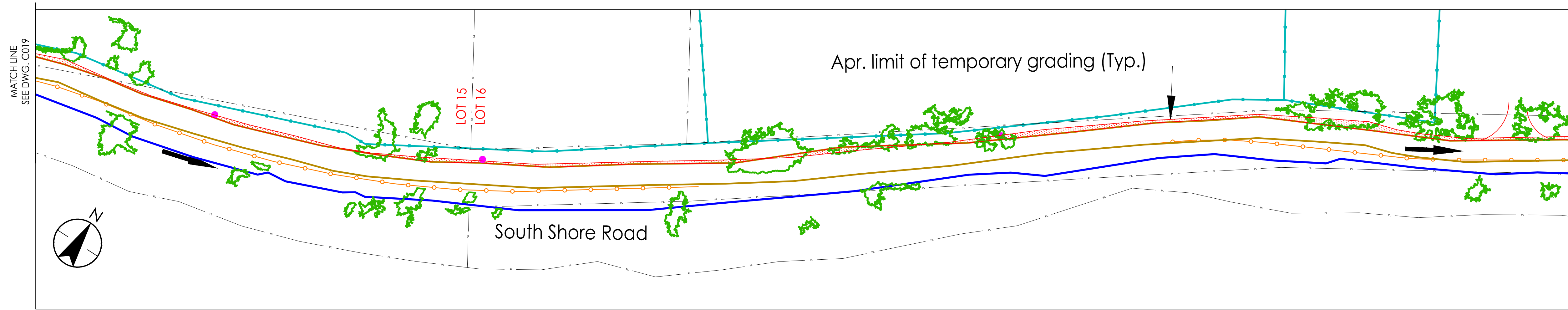

GOING NORTH-EAST ON SOUTH SHORE ROAD

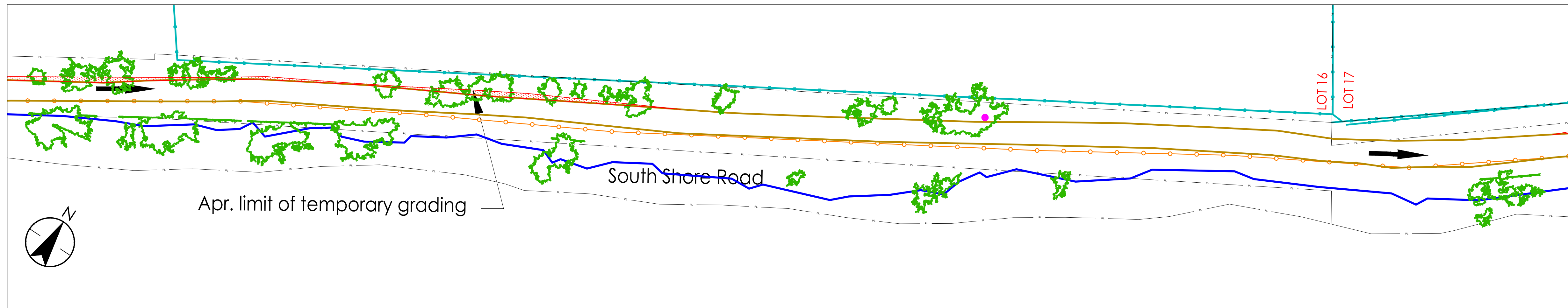

GOING NORTH-EAST ON SOUTH SHORE ROAD

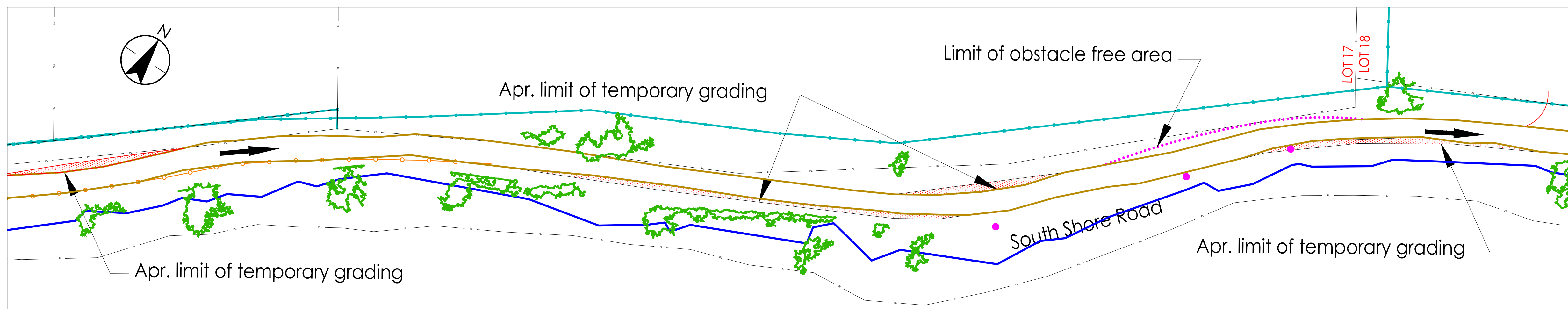

GOING NORTH-EAST ON SOUTH SHORE ROAD

\\C:\10401\work\proj\133560078\133560078.dwg 2016/12/21 4:04 PM By: L.L. (s)

